

# A12 | 刀杆 Holder

本系列主要应用于走芯机车床  
The series mainly used in SWISS lathe

ER/L-前扫刀杆,适配A12系列前扫,槽刀,螺纹刀片  
ER/L-Front turning holder, match A12 series insert of  
Front turning, grooving and threading.

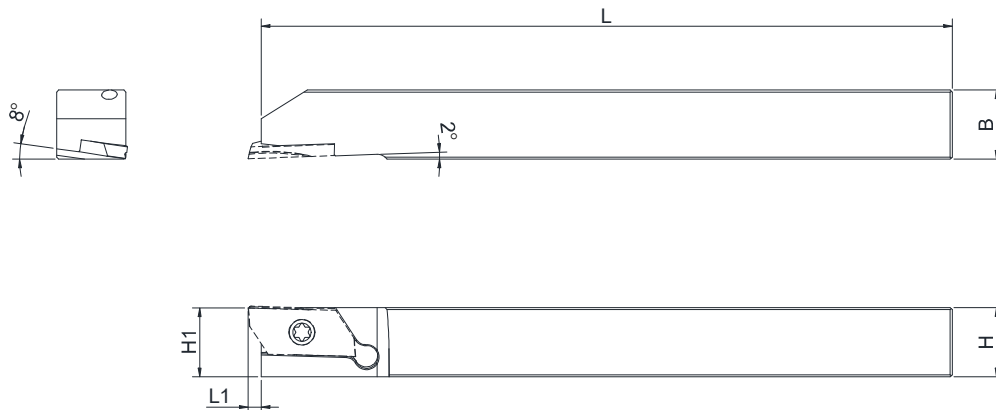

>图示为右手刀杆  
>Shown in right version  
>配套刀片参考第 D04~D10 页  
>Related inserts refer to page D04~D10

刀杆型号 Holder model	主要尺寸 Dimensions					参考图示 Rated Figure	适配刀片 Rated Inserts	配件 Accessories	
	H	B	L	H1	L1			螺丝 Screw	扳手 Wrench
ER/L1010K-A12 ●	10.0	10.0	120	10.0	3.0	Figure A	A12.EXX.XXX.XX	M3.0*7	T10
ER/L1212K-A12 ●	12.0	12.0	120	12.0	3.0	Figure A	A12.EXX.XXX.XX	M3.0*7	T10
ER/L1616K-A12 ●	16.0	16.0	120	16.0	3.0	Figure A	A12.EXX.XXX.XX	M3.0*7	T10

●标准备库产品/Standard in stock ○按订单生产产品/Make to order

BR-后扫刀杆,适配A12系列后扫刀片及切断刀片  
BR-Back turning holder, match A12 series insert of  
Back turning and cut-off.

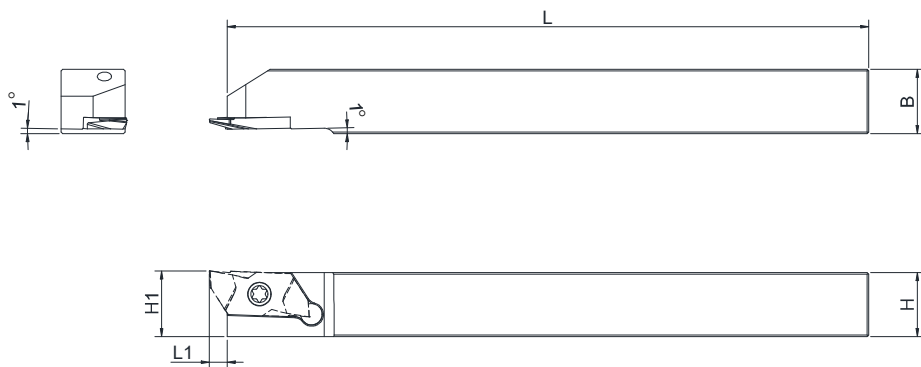

>图示为右手刀杆  
>Shown in right version  
>配套刀片参考第 D04~D10 页  
>Related inserts refer to page D04~D10

刀杆型号 Holder model	主要尺寸 Dimensions					参考图示 Rated Figure	适配刀片 Rated Inserts	配件 Accessories	
	H	B	L	H1	L1			螺丝 Screw	扳手 Wrench
BR/L1010K-A12 ●	10.0	10.0	120	10.0	3.0	Figure A	A12.BXX.XXX.XX	M3.0*7	T10
BR/L1212K-A12 ●	12.0	12.0	120	12.0	3.0	Figure A	A12.BXX.XXX.XX	M3.0*7	T10
BR/L1616K-A12 ●	16.0	16.0	120	16.0	3.0	Figure A	A12.BXX.XXX.XX	M3.0*7	T10

●标准备库产品/Standard in stock ○按订单生产产品/Make to order

# A12 | 刀杆 Holder

本系列主要应用于走芯机床  
The series mainly used in SWISS lathe

WER-弯头前扫刀杆,适配A12系列前扫,槽刀,螺纹刀片  
WER-Front turning holder, match A12 series insert of  
Front turning, grooving and threading.

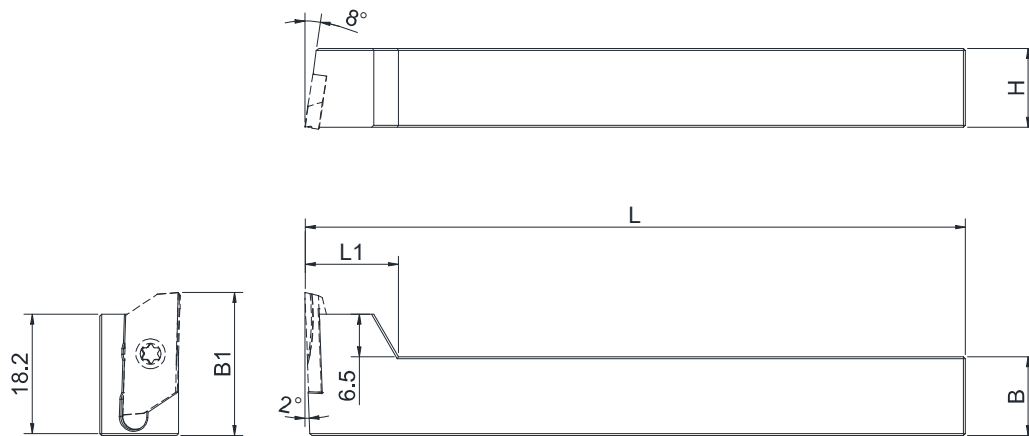

>图示为右手刀杆  
>Shown in right version  
>配套刀片参考 第 D04~D10 页  
>Related inserts refer to page D04~D10

刀杆型号 Holder model	主要尺寸 Dimensions					参考图示 Rated Figure	适配刀片 Rated Inserts	配件 Accessories	
	H	B	L	B1	L1			螺丝 Screw	扳手 Wrench
WER1212H-A12 ●	12.0	12.0	100	22.0	16.0	Figure A	A12.EXX.XXX.XX	M3.0*7	T10
WER1616H-A12 ●	16.0	16.0	100	22.0	16.0	Figure A	A12.EXX.XXX.XX	M3.0*7	T10

● 标准备库产品/Standard in stock ○ 按订单生产产品/Make to order

WBR-弯头后扫刀杆,适配A12系列后扫刀片及切断刀片  
WBR-Back turning holder, match A12 series insert of  
Back turning and cut-off.

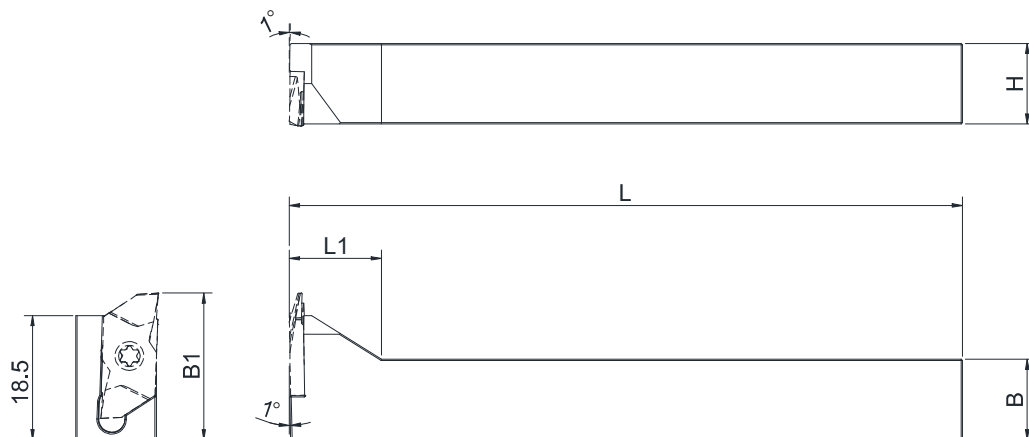

>图示为右手刀杆  
>Shown in right version  
>配套刀片参考 第 D04~D10 页  
>Related inserts refer to page D04~D10

刀杆型号 Holder model	主要尺寸 Dimensions					参考图示 Rated Figure	适配刀片 Rated Inserts	配件 Accessories	
	H	B	L	B1	L1			螺丝 Screw	扳手 Wrench
BR/L1212K-A12 ●	12.0	12.0	100	22.0	16.0	Figure A	A12.BXX.XXX.XX	M3.0*7	T10
BR/L1616K-A12 ●	16.0	16.0	100	22.0	16.0	Figure A	A12.BXX.XXX.XX	M3.0*7	T10

● 标准备库产品/Standard in stock ○ 按订单生产产品/Make to order

# A12 | 背轴加工用刀杆

## For Sub-Spindle Holder

本系列主要应用于走芯机床  
The series mainly used in SWISS lathe

BL-背轴切断刀杆,适配A12系列左手后扫,左手槽刀,左手螺纹刀片及切断刀片  
BL-For Sub-Spindle turning holder, match A12 series left inserts of back turning, grooving, threading and cut-off

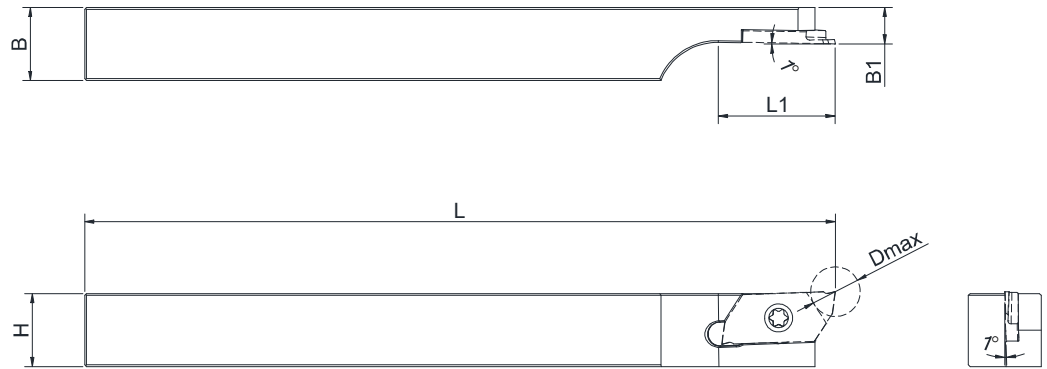

>图示为右手刀杆  
>Shown in right version  
>配套刀片参考 第 D04~D10 页  
>Related inserts refer to page D04~D10

刀杆型号 Holder model	主要尺寸 Dimensions					参考图示 Rated Figure	适配刀片 Rated Inserts	配件 Accessories	
	H	B	L	B1	L1			螺丝 Screw	扳手 Wrench
ER/L1010K-A12 ●	10.0	10.0	120	6.00	20.5	Figure A	A12.BXX.XXX.XX	M3.0*5	T10
ER/L1212K-A12 ●	12.0	12.0	120	6.00	20.5	Figure A	A12.BXX.XXX.XX	M3.0*5	T10
ER/L1616K-A12 ●	16.0	16.0	120	6.00	20.5	Figure A	A12.BXX.XXX.XX	M3.0*5	T10

● 标准备库产品/Standard in stock ○ 按订单生产产品/Make to order

ER\*\*-SUB-背轴刀杆,适配A12系列前扫刀片及插扫刀片  
ER\*\*-SUB-For Sub-Spindle turning holder, match A12 series inserts of Front turning and grooving turning

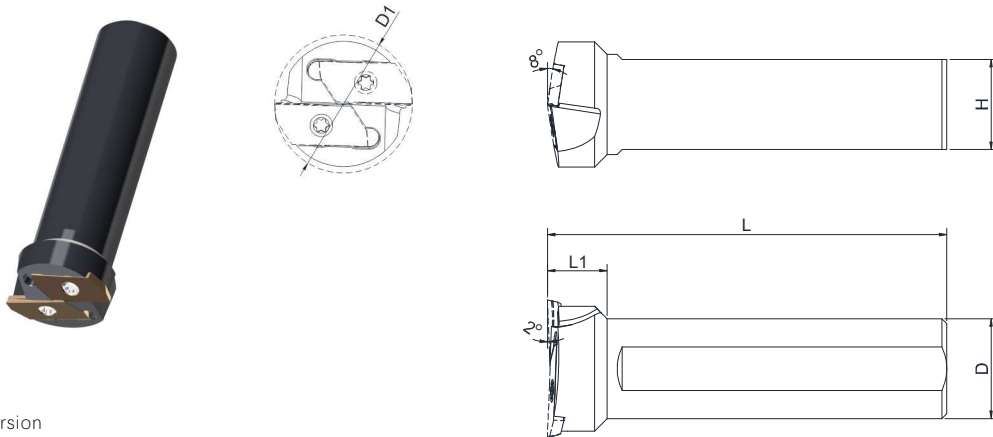

>图示为右手刀杆  
>Shown in right version  
>配套刀片参考 第 D04~D10 页  
>Related inserts refer to page D04~D10

刀杆型号 Holder model	主要尺寸 Dimensions					参考图示 Rated Figure	适配刀片 Rated Inserts	配件 Accessories	
	H	D	L	D1	L1			螺丝 Screw	扳手 Wrench
ER16F-SUB-A12 ●	15.0	16.0	85	27.0	5.0	Figure A	A12.EXX.XXX.XX	M3.0*7	T10
ER20F-SUB-A12 ●	18.0	20.0	85	27.0	5.0	Figure A	A12.EXX.XXX.XX	M3.0*7	T10
ER22F-SUB-A12 ●	21.5	22.5	85	27.0	5.0	Figure A	A12.EXX.XXX.XX	M3.0*7	T10

● 标准备库产品/Standard in stock ○ 按订单生产产品/Make to order

# A12 | 前扫

## Front Turning

本系列主要应用于走芯机车床  
The series mainly used in SWISS lathe

AF-通用槽型,适合大多数工况  
AF-Chip breaker for general condition

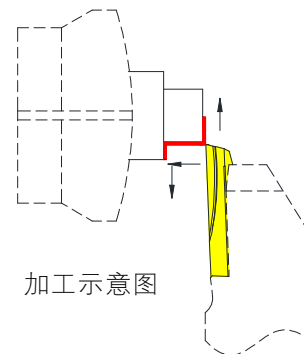
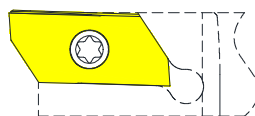
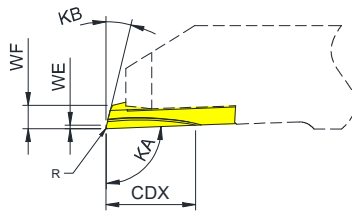
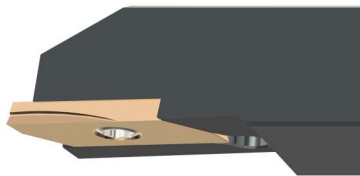

加工示意图

- > 图示为右手刀片
- > Shown in right version
- > 配套刀杆参考第 D01~D03 页
- > Related holder refer to page A18
- > 切削参数请参考第 A04 页
- > Cutting condition refer to page A04.

刀片型号 Insert model	主要尺寸 Dimensions						材质 Grades			
	R	KA	KB	WE	WF	CDX	AS3215	AS1015	AS2015	AM12
A12.EER/L00.A12.400.AF	0.00	92°	12°	0.0	2.1	4.0	●	●	○	○
A12.EER/L05.A12.400.AF	0.05	90°	12°	0.0	2.1	5.0	●	●	○	○
A12.EER/L10.A12.400.AF	0.10	90°	12°	0.0	2.1	8.0	●	●	○	○
A12.EER/L20.A12.400.AF	0.20	90°	12°	0.0	2.1	8.0	●	●	○	○

● 标准库产品/Standard in stock ○ 按订单生产产品/Make to order

DP-更加锋利的槽型,更好的切屑控制能力,适合粘性材加工  
DP-More sharp edge, for better chip control performance

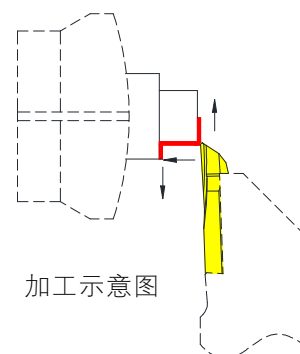
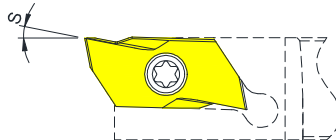
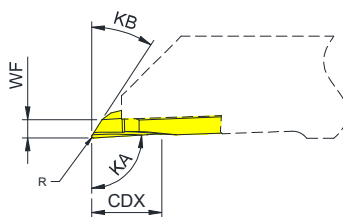
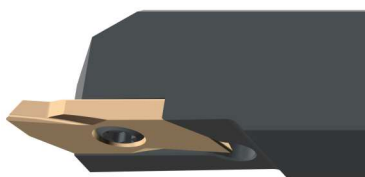

加工示意图

- > 图示为右手刀片
- > Shown in right version
- > 配套刀杆参考第 D01~D03 页
- > Related holder refer to page 18~21
- > 切削参数请参考第 A04 页
- > Cutting condition refer to page A04.

刀片型号 Insert model	主要尺寸 Dimensions						材质 Grades			
	R	KA	KB	S	WF	CDX	AS3215	AS1015	AS2015	AM12
A12.EER/L05.A35.400.DP	0.05	92°	35°	12°	2.2	4.0	●	●	○	○
A12.EER/L10.A35.400.DP	0.10	92°	35°	12°	2.2	4.0	●	●	○	○
A12.EER/L20.A35.400.DP	0.20	92°	35°	12°	2.2	4.0	●	●	○	○
A12.EER/L40.A35.400.DP	0.40	92°	35°	12°	2.2	4.0	●	●	○	○

● 标准库产品/Standard in stock ○ 按订单生产产品/Make to order

# A12 | 插扫 Grooving Turning

本系列主要应用于走芯机车床  
The series mainly used in SWISS lathe

TA-可车削槽刀片槽型  
TA-Chip breaker for grooving turning.

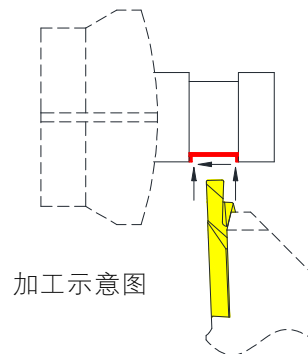
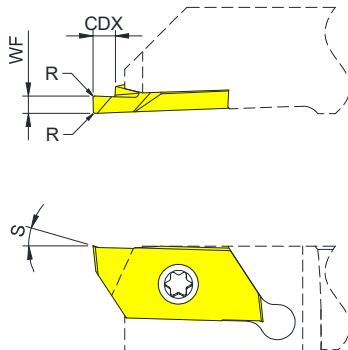
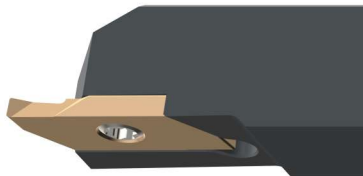

加工示意图

- > 图示为右手刀片
- > Shown in right version
- > 配套刀杆参考第 D01~D03 页
- > Related holder refer to page A18
- > 切削参数请参考第 A04 页
- > Cutting condition refer to page A04.

该刀片切宽及切深均可定制。  
Both the edge width and cut deep can be made to order

刀片型号 Insert model	主要尺寸 Dimensions						材质 Grades			
	R	KA	S	CDX	WF	APMX	AS3215	AS1015	AS2015	AM12
A12.EGR/L00.050.080.TA	0.00	90°	25°	0.80	0.50	0.80	●	●	○	○
A12.EGR/L05.075.120.TA	0.05	90°	25°	1.20	0.75	1.20	●	●	○	○
A12.EGR/L05.100.160.TA	0.05	90°	25°	1.60	1.00	1.60	●	●	○	○
A12.EGR/L10.150.240.TA	0.10	90°	25°	2.40	1.50	2.40	○	○	○	○
A12.EGR/L15.200.320.TA	0.15	90°	25°	3.20	2.00	3.20	●	●	○	○

● 标准库产品/Standard in stock ○ 按订单生产产品/Make to order

FR-全圆弧槽刀片  
FR-Full radius grooving insert

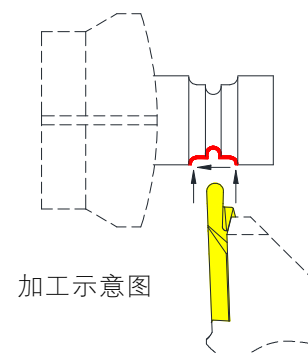
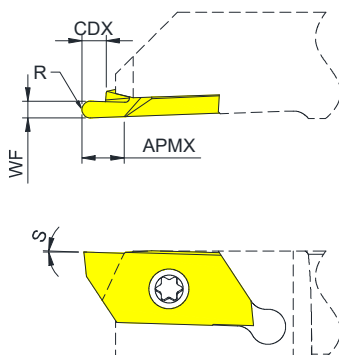
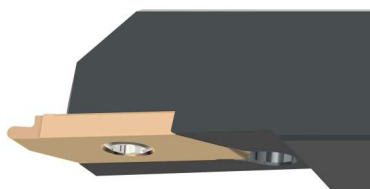

加工示意图

- > 图示为右手刀片
- > Shown in right version
- > 配套刀杆参考第 D01~D03 页
- > Related holder refer to page A18
- > 切削参数请参考第 A04 页
- > Cutting condition refer to page A04.

该刀片切宽及切深均可定制。  
Both the edge width and cut deep can be made to order

刀片型号 Insert model	主要尺寸 Dimensions						材质 Grades			
	R	KA	S	CDX	WF	APMX	AS3215	AS1015	AS2015	AM12
A12.EGR/L25.050.150.FR	0.25	90°	5°	1.50	0.50	1.50	●	●	○	○
A12.EGR/L30.060.180.FR	0.30	90°	5°	1.80	0.75	1.80	●	●	○	○
A12.EGR/L40.080.240.FR	0.40	90°	5°	2.40	1.00	2.40	●	●	○	○
A12.EGR/L50.100.300.FR	0.50	90°	5°	3.00	1.50	3.00	●	●	○	○
A12.EGR/L75.150.450.FR	0.75	90°	5°	4.50	2.00	4.50	●	●	○	○
A12.EGR/L100.200.600.FR	1.00	90°	5°	6.00	1.50	6.00	●	●	○	○

● 标准库产品/Standard in stock ○ 按订单生产产品/Make to order

# A12 | 后扫 Back Turning

本系列主要应用于走芯机车床  
The series mainly used in SWISS lathe

AF-通用槽型,适合大多数工况  
AF-Chip breaker for general condition

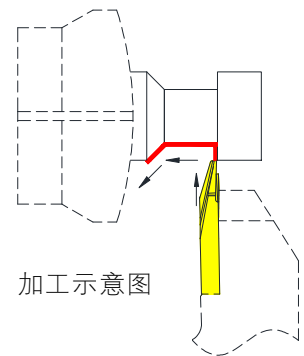
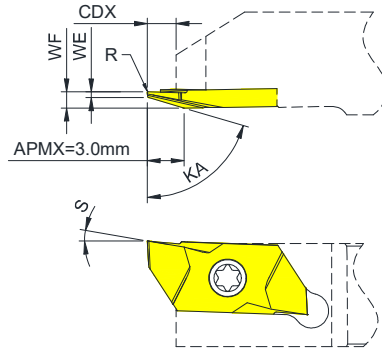
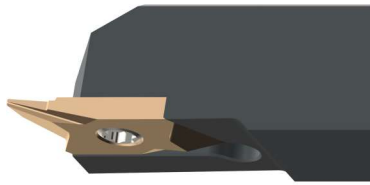

加工示意图

- > 图示为右手刀片
- > Shown in right version
- > 配套刀杆参考第 D01~D03 页
- > Related holder refer to page A18
- > 切削参数请参考第 A04 页
- > Cutting condition refer to page A04.

刀片型号 Insert model	主要尺寸 Dimensions						材质 Grades			
	R	KA	S	WE	WF	CDX	AS3215	AS1015	AS2015	AM12
A12.BBR/L00.A75.400.AF	0.00	75°	10°	0.7	2.0	4.0	●	●	○	○
A12.BBR/L05.A75.400.AF	0.05	75°	10°	0.7	2.0	4.0	●	●	○	○
A12.BBR/L10.A75.400.AF	0.10	75°	10°	0.7	2.0	4.0	●	●	○	○
A12.BBR/L20.A75.400.AF	0.20	75°	10°	0.7	2.0	4.0	●	●	○	○

● 标准备库产品/Standard in stock ○ 按订单生产产品/Make to order

VF-更加锋利的槽型,更好的切屑控制能力,适合粘性材加工  
VF-More sharp edge, for better chip control performance

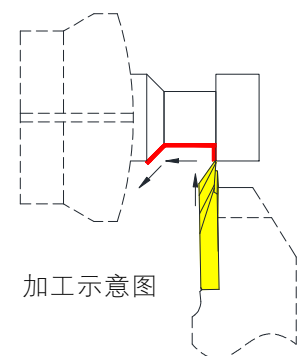
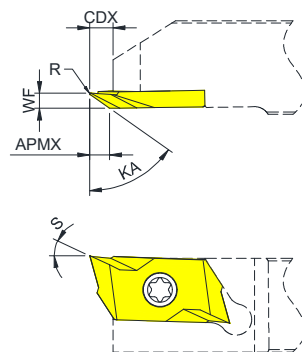
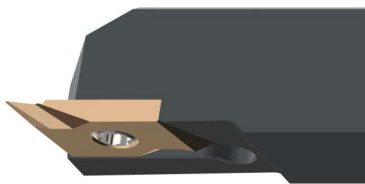

加工示意图

- > 图示为右手刀片
- > Shown in right version
- > 配套刀杆参考第 D01~D03 页
- > Related holder refer to page 18~21
- > 切削参数请参考第 A04 页
- > Cutting condition refer to page A04.

刀片型号 Insert model	主要尺寸 Dimensions						材质 Grades			
	R	KA	APMX	S	WF	CDX	AS3215	AS1015	AS2015	AM12
A12.BBR/L05.A55.400.VF	0.05	55°	2.0	25°	2.0	4.0	●	●	○	○
A12.BBR/L10.A55.400.VF	0.10	55°	2.0	25°	2.0	4.0	●	●	○	○
A12.BBR/L20.A55.400.VF	0.20	55°	2.0	25°	2.0	4.0	●	●	○	○
A12.BBR/L40.A55.400.VF	0.40	55°	2.0	25°	2.0	4.0	○	○	○	○

● 标准备库产品/Standard in stock ○ 按订单生产产品/Make to order

# A12 | 切断

## Cut Off

本系列主要应用于走芯机车床  
The series mainly used in SWISS lathe

AF-通用槽型,适合大多数工况  
AF-Chip breaker for general condition

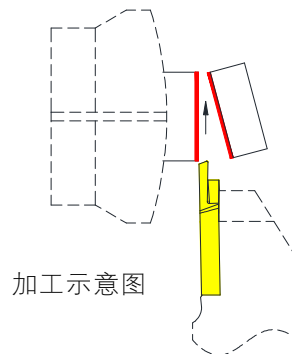
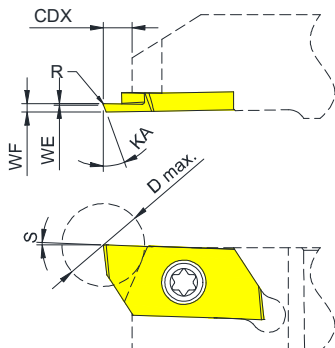

加工示意图

- > 图示为右手刀片
- > Shown in right version
- > 配套刀杆参考第 D01~D03 页
- > Related holder refer to page A18
- > 切削参数请参考第 A04 页
- > Cutting condition refer to page A04.

该刀片切宽及切深均可定制。  
Both the edge width and cut deep can be made to order

刀片型号 Insert model	主要尺寸 Dimensions						材质 Grades			
	R	KA	S	D max.	WF	CDX	AS3215	AS1015	AS2015	AM12
A12.BCR/L00.050.D03.AF	0.00	12°	5°	3.0	0.50	6.0	●	●	○	○
A12.BCR/L00.075.D06.AF	0.05	12°	5°	6.0	0.75	6.0	●	●	○	○
A12.BCR/L05.100.D10.AF	0.05	15°	5°	8.0	1.00	6.0	●	●	○	○
A12.BCR/L05.150.D12.AF	0.05	15°	5°	12.0	1.50	6.0	●	●	○	○

● 标准库产品/Standard in stock ○ 按订单生产产品/Make to order

VF-更加锋利的槽型,更好的切屑控制能力,适合粘性材加工  
VF-More sharp edge, for better chip control performance

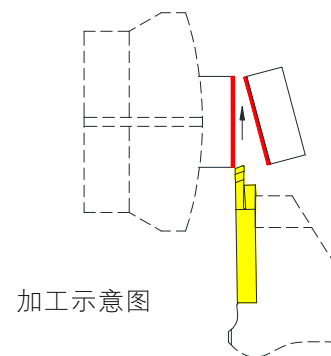
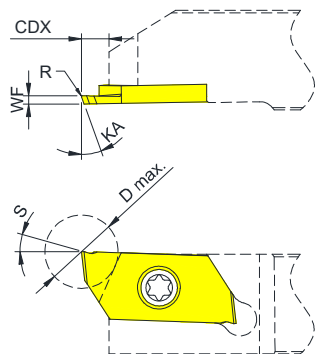
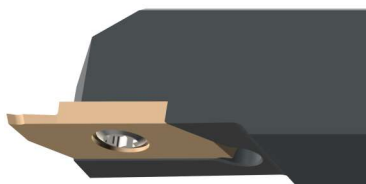

加工示意图

- > 图示为右手刀片
- > Shown in right version
- > 配套刀杆参考第 D01~D03 页
- > Related holder refer to page 18~21
- > 切削参数请参考第 A04 页
- > Cutting condition refer to page A04.

该刀片切宽及切深均可定制。  
Both the edge width and cut deep can be made to order

刀片型号 Insert model	主要尺寸 Dimensions						材质 Grades			
	R	KA	S	D max.	WF	CDX	AS3215	AS1015	AS2015	AM12
A12.BCR/L00.050.D03.VF	0.00	12°	12°	3.0	0.50	6.0	●	●	○	○
A12.BCR/L05.075.D06.VF	0.05	12°	12°	6.0	0.75	6.0	●	●	○	○
A12.BCR/L05.100.D08.VF	0.05	15°	12°	8.0	1.00	6.0	●	●	○	○
A12.BCR/L05.150.D12.VF	0.05	15°	12°	12.0	1.50	6.0	●	●	○	○

● 标准库产品/Standard in stock ○ 按订单生产产品/Make to order

# A12 | 切槽 Grooving

本系列主要应用于走芯机车床  
The series mainly used in SWISS lathe

AF-通用槽型,适合大多数工况  
AF-Chip breaker for general condition

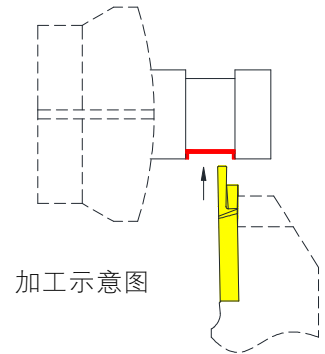
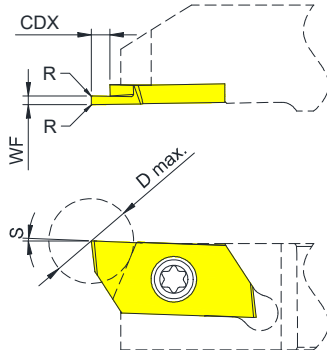
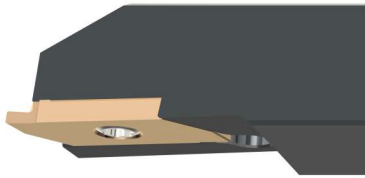

- > 图示为右手刀片
- > Shown in right version
- > 配套刀杆参考第 D01~D04 页
- > Related holder refer to page A18
- > 切削参数请参考第 A04 页
- > Cutting condition refer to page A04.

该刀片切宽及切深均可定制。  
Both the edge width and cut deep can be made to order

刀片型号 Insert model	主要尺寸 Dimensions						材质 Grades			
	R	KA	S	D max.	WF	CDX	AS3215	AS1015	AS2015	AM12
A12.BGR/L00.015.030.AF	0.00	90°	5°	12.0	0.15	0.30	●	●	○	○
A12.BGR/L00.020.040.AF	0.00	90°	5°	12.0	0.20	0.40	●	●	○	○
A12.BGR/L00.025.050.AF	0.00	90°	5°	12.0	0.25	0.50	●	●	○	○
A12.BGR/L00.030.060.AF	0.00	90°	5°	12.0	0.30	0.60	●	●	○	○
A12.BGR/L00.040.080.AF	0.00	90°	5°	12.0	0.40	0.80	●	●	○	○
A12.BGR/L00.045.090.AF	0.00	90°	5°	12.0	0.45	0.90	●	●	○	○
A12.BGR/L00.050.100.AF	0.00	90°	5°	12.0	0.50	1.00	●	●	○	○
A12.BGR/L05.050.100.AF	0.05	90°	5°	12.0	0.50	1.00	●	●	○	○
A12.BGR/L00.060.120.AF	0.00	90°	5°	12.0	0.60	1.20	●	●	○	○
A12.BGR/L05.060.120.AF	0.05	90°	5°	12.0	0.60	1.20	●	●	○	○
A12.BGR/L00.075.200.AF	0.00	90°	5°	12.0	0.75	1.50	●	●	○	○
A12.BGR/L05.075.200.AF	0.05	90°	5°	12.0	0.75	1.50	●	●	○	○
A12.BGR/L00.080.200.AF	0.00	90°	5°	12.0	0.80	1.60	●	●	○	○
A12.BGR/L05.080.200.AF	0.05	90°	5°	12.0	0.80	1.60	●	●	○	○
A12.BGR/L05.090.200.AF	0.05	90°	5°	12.0	0.90	1.80	●	●	○	○
A12.BGR/L05.095.200.AF	0.05	90°	5°	12.0	0.95	1.90	●	●	○	○
A12.BGR/L05.100.200.AF	0.05	90°	5°	12.0	1.00	2.00	●	●	○	○
A12.BGR/L05.115.200.AF	0.05	90°	5°	12.0	1.15	2.30	●	●	○	○
A12.BGR/L05.120.200.AF	0.05	90°	5°	12.0	1.20	2.40	●	●	○	○
A12.BGR/L10.135.200.AF	0.10	90°	5°	12.0	1.35	2.70	●	●	○	○
A12.BGR/L10.150.200.AF	0.10	90°	5°	12.0	1.50	3.00	●	●	○	○
A12.BGR/L10.205.200.AF	0.10	90°	5°	12.0	2.05	4.10	●	●	○	○

● 标准备库产品/Standard in stock ○ 按订单生产产品/Make to order

# A12 | 螺纹

## THREADING

本系列主要应用于走芯机车床  
The series mainly used in SWISS lathe

AG-通用泛牙型刀片  
AG-For partial profile threading

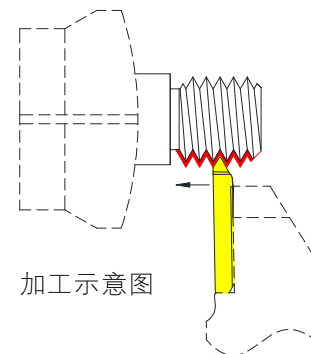
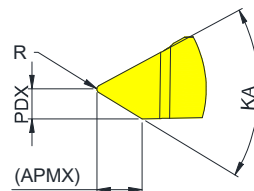
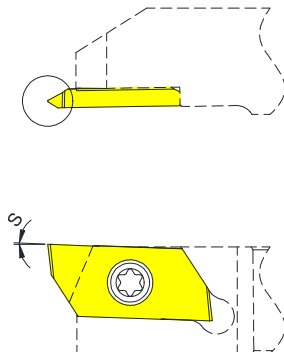
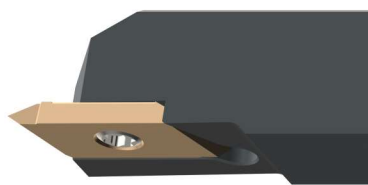

加工示意图

- > 图示为右手刀片
- > Shown in right version
- > 配套刀杆参考第 D01~D04 页
- > Related holder refer to page A18
- > 切削参数请参考第 A04 页
- > Cutting condition refer to page A04.

该刀片切宽及切深均可定制。  
Both the edge width and cut deep can be made to order

刀片型号 Insert model	主要尺寸 Dimensions						材质 Grades			
	R	KA	S	APMX	PDX	CDX	AS3215	AS1015	AS2015	AM12
A12.BTR/L03.A60.020.AG	0.03	60°	2°	0.35	0.25	6.0	●	●	○	○
A12.BTR/L03.A60.025.AG	0.03	60°	2°	0.35	0.25	6.0	●	●	○	○
A12.BTR/L10.A60.075.AG	0.05	60°	2°	1.00	0.75	6.0	●	●	○	○
A12.BTR/L03.A55.025.AG	0.05	55°	2°	1.00	0.25	6.0	●	●	○	○
A12.BTR/L10.A55.075.AG	0.05	55°	2°	1.00	0.75	6.0	●	●	○	○

● 标准库存产品/Standard in stock ○ 按订单生产产品/Make to order

ISO-全牙型刀片  
ISO-For full profile threading

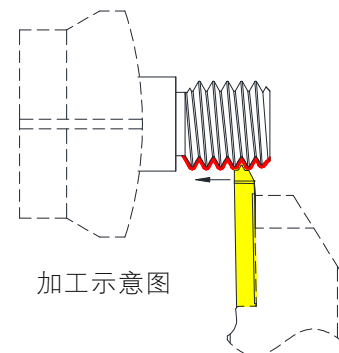
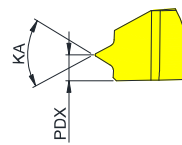
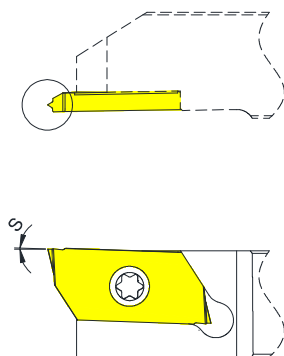
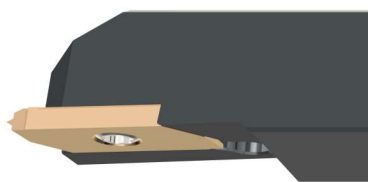

加工示意图

- > 图示为右手刀片
- > Shown in right version
- > 配套刀杆参考第 D01~D04 页
- > Related holder refer to page 18~21
- > 切削参数请参考第 A04 页
- > Cutting condition refer to page A04.

该刀片切宽及切深均可定制。  
Both the edge width and cut deep can be made to order

刀片型号 Insert model	主要尺寸 Dimensions						材质 Grades			
	R	KA	S	APMX	PDX	CDX	AS3215	AS1015	AS2015	AM12
A12.BTR/L-0.20-ISO	0.03	60°	2°	0.30	0.25	6.0	○	○	○	○
A12.BTR/L-0.25-ISO	0.03	60°	2°	0.35	0.25	6.0	○	○	○	○
A12.BTR/L-0.50-ISO	0.05	60°	2°	1.00	0.75	6.0	○	○	○	○
A12.BTR/L-0.75-ISO	0.09	60°	2°	1.35	1.00	6.0	○	○	○	○

● 标准库存产品/Standard in stock ○ 按订单生产产品/Make to order